

12 11 10 9 8 7 6 5 4 3 2 1

H
G
F
E
D
C
B
A

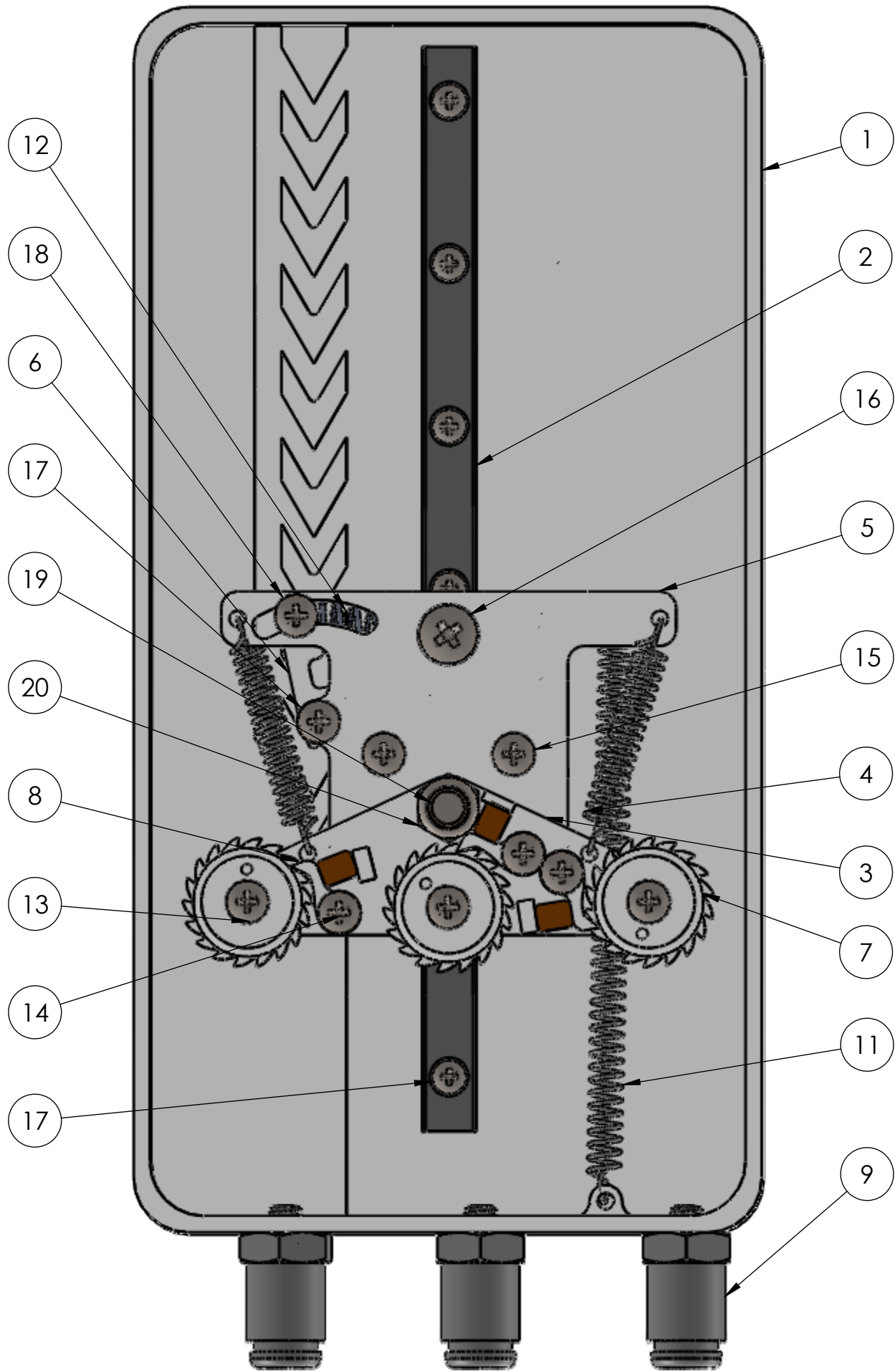

ITEM NO.	PART NUMBER	QTY.
1	Differential Box	1
2	Slider Rail	1
3	Whiffletree Base	1
4	Whiffletree Springs	2
5	Rail attachment	1
6	Teeth Lever	1
7	Pulley	3
8	Ratchet	3
9	Tube Connector	3
10	Back attachment	1
11	Rail Spring	1
12	Teeth Spring	1
13	M2 x 8 mm Screw	3
14	M2 x 4 mm Screw	4
15	M2 x 6 mm Screw	2
16	M3 x 5 mm Screw	1
17	M2 x 5 mm Screw	6
18	M2 x 10 mm Screw	3
19	M3 x 10 mm Screw	1
20	M3 x 6 mm Countersunk Screw	1
21	M3 Lock Nut	1
24	M3 Nut	2

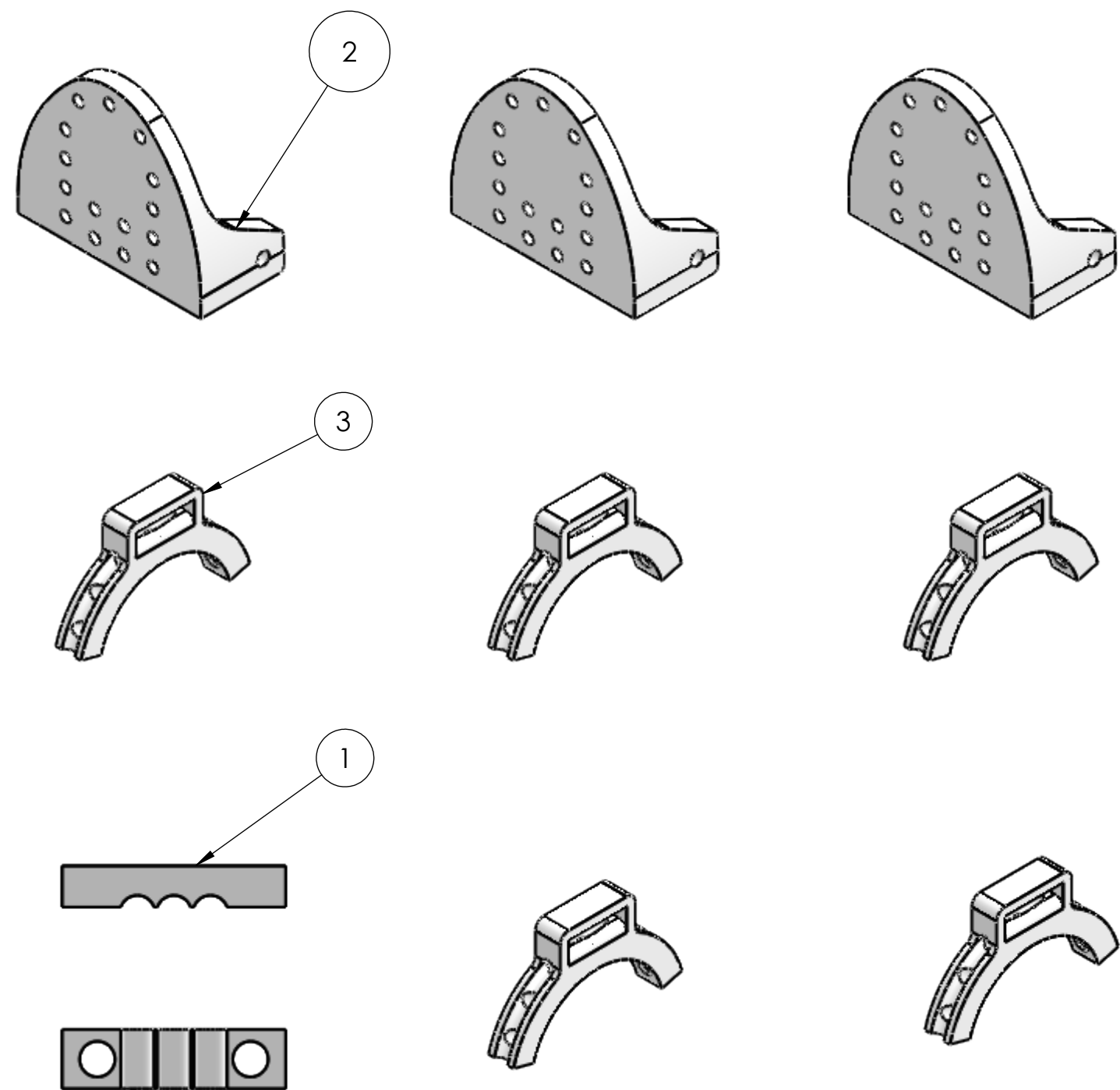

ITEM NO.	PART NUMBER	QTY.
1	Tube Holder	2
2	Fingernails Connection	3
3	Back Anchor	5
4	Shoulder Harness	1
5	Glove	1
6	3mm PU tubing (m)	5
7	Braided Fiber Wire 40kg (m)	10
8	Rubber band	3
9	Retractable key chain	1

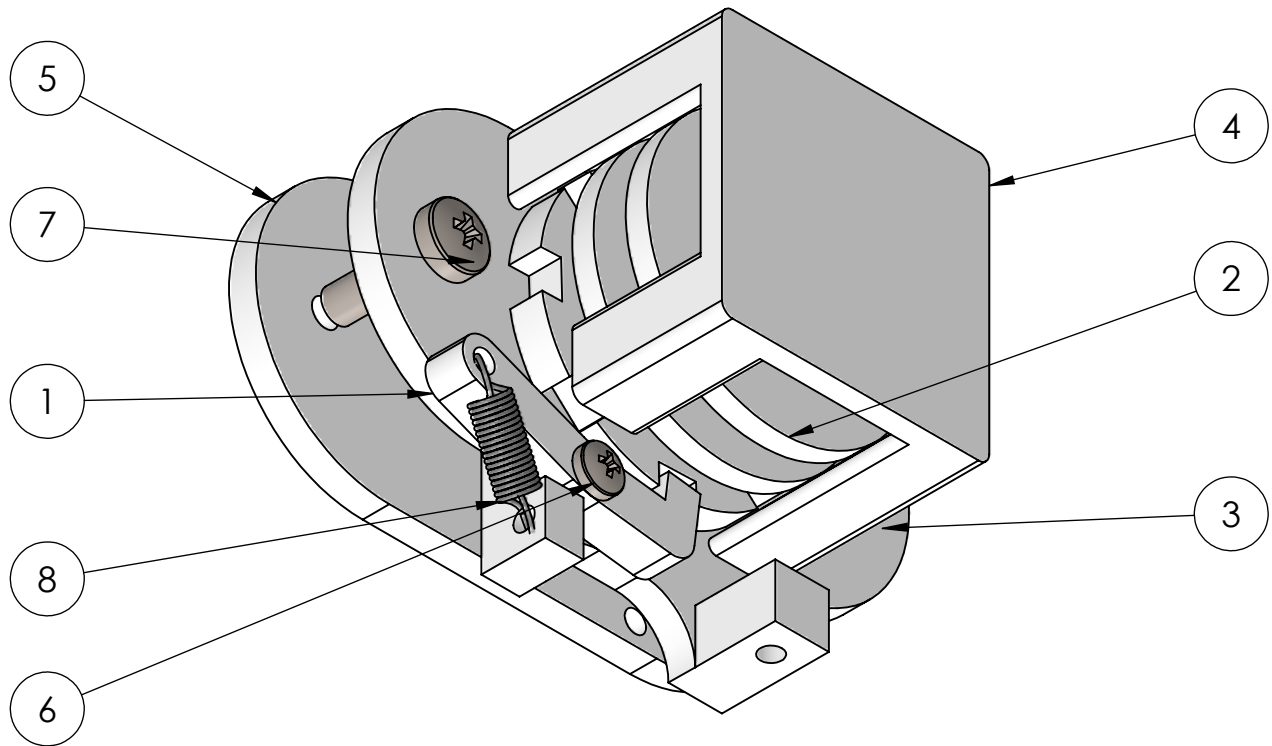

ITEM NO.	PART NUMBER	QTY.
1	Lever	1
2	Pulley	1
3	Base	1
4	Cover	1
5	Back Attachment	1
6	M2 x 6 mm Screw	1
7	M3 x 10 mm Screw	2
8	Lever Spring	1
9	Braided Fiber Wire 100kg (m)	1
10	Retractable Keychain	1
11	Ball Bearing 13mm x 4mm x 5mm	2
12	M4 x 16 mm Screw	1

UNLESS OTHERWISE SPECIFIED: DIMENSIONS ARE IN MILLIMETERS SURFACE FINISH: TOLERANCES: LINEAR: ANGULAR:				FINISH:		DEBURR AND BREAK SHARP EDGES		DO NOT SCALE DRAWING		REVISION	
DRAWN				NAME		SIGNATURE		DATE		TITLE:	
CHK'D										Body Powered Exoskeleton Glove	
APPVD										DWG NO.	
MFG										Bill of Materials	
Q.A										A2	
										SCALE:2:1	
										SHEET 1 OF 1	

12 11 10 9 8 7 6 5 4 3 2 1